

3532 INSTA-FLANGE ADAPTER (HEAVY DUTY)

BODY CASTING: Ductile Iron per ASTM A536.

SET SCREWS: AISI 4140 Heat Treated Steel.

GASKET: SBR Mechanical Joint design per ASTM D2000. Suitable for mild acids, water, and salt.

FINISH: Epoxy.

FLANGE DRILLING: ANSI B16.1 125# / ANSI B16.5 150#.



Flange Size (125# Flange)		Type of Pipe	Pipe OD Range		Flange OD Dim - A		Body Length Dim - B		Bolt Circle-Dim - C		Set Screws		Working Pressure	Approx. Weight		Part Number	List Price
Inches	MM		Inches	MM	Inches	MM	Inches	MM	Inches	MM	Qty.	size		lbs.	kgs		
4	100	A Steel	4.50	114	9.0	229	2.1	53.3	7.5	191	8	1/2	250	10	5	35320400000S	\$ 104.50
		B Ductile Iron	4.80	122												35320400000C	
6	150	A Steel	6.63	168	11.0	279	2.1	53.3	9.5	241	8	5/8	250	19	9	35320600000S	\$ 112.50
		B Ductile Iron	6.90	175												35320600000C	
8	200	A Steel	8.63	219	13.5	343	2.1	53.3	11.8	298	8	5/8	250	24	11	35320800000S	\$ 131.50
		B Ductile Iron	9.05	230												35320800000C	
10	250	A Steel	10.75	273	16.0	406	2.1	53.3	14.3	363	12	5/8	250	28	13	35321000000S	\$ 282.00
		B Ductile Iron	11.10	282												35321000000C	
12	300	A Steel	12.75	324	19.0	483	2.2	55.9	17.0	432	12	5/8	250	47	21	35321200000S	\$ 328.60
		B Ductile Iron	13.20	335												35321200000C	
14	350	A Steel	14.00	356	21.0	533	2.6	66	18.8	478	12	5/8	150	66	30	35321400000S	\$ 387.30
		B Ductile Iron	15.30	389												35321400000C	
16	400	A Steel	16.00	406	23.5	597	2.7	68.6	21.3	541	16	5/8	150	69	31	35321600000S	\$ 515.00
		B Ductile Iron	17.40	442												35321600000C	
18	450	A Steel	18.00	457	25.0	635	2.8	71.1	22.8	579	16	3/4	150	76	34	35321800000S	\$ 686.70
		B Ductile Iron	19.50	495												35321800000C	
20	500	A Steel	20.00	508	27.5	699	2.9	73.7	25.0	635	20	3/4	150	84	38	35322000000S	\$ 915.70
		B Ductile Iron	21.60	549												35322000000C	
24	600	A Steel	24.00	610	32.0	813	3.1	78.7	29.5	749	20	3/4	150	114	52	35322400000S	\$ 1,220.90
		B Ductile Iron	25.80	655												35322400000C	
30	750	A Steel	30.00	762	38.8	986	4.0	101.6	36.0	914	28	3/4	100	196	89	35323000000S	\$ 1,627.80
		B Ductile Iron	32.00	813												35323000000C	
36	900	A Steel	36.00	914	46.0	1168	4.5	114.3	42.3	1074	32	3/4	100	282	128	35323600000S	\$ 2,873.80
		B Ductile Iron	38.30	973												35323600000C	

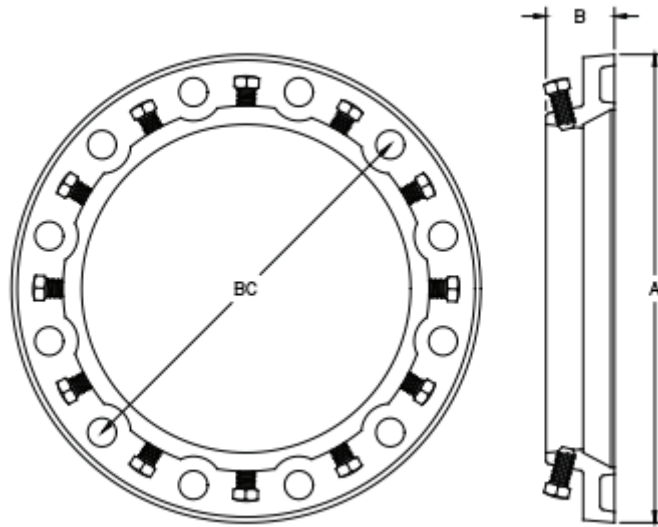

HOW TO ORDER: Specify Model Number, Pipe Size with Letter Code. **EXAMPLE:** 6" Flanged Valve to 6" Ductile Iron O.D. 6.90. Order 3531 - 6B. **Part Number:** 35320600000C .