

MODEL 3538 COUPLING

CENTER BARREL: Carbon Steel per ASTM A53 or ASTM A 283 (DICE 2b3).

END GLAND: Carbon Steel per AISI C1020.

BOLTS & NUTS: Low Alloy Steel per ASTM A325, ASTM A563, and AWWA C111.

GASKET: SBR per ASTM D2000. Suitable for mild acids, water, and salt media with a temperature range of -25° F to -200° F. Optional materials available.

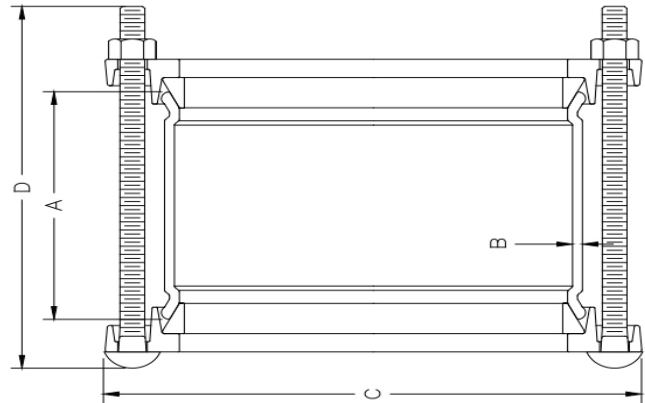

Nominal Pipe Size		Pipe OD Range		Barrel Length Dim-A		Barrel Thickness Dim-B		Gland OD Dim-C		Overall Length Dim-D		Coupling		Weight		Working Pressure PSI
Inches	MM	Inches	MM	Inches	MM	Inches	MM	Inches	MM	Inches	MM	Catalog Number	List Price	lbs	kgs	
4	100	4.50	114	5.00	127	0.20	5	8.20	208	6.50	165	3538045005EO	\$152.30	13	6	1200
		4.50	114	7.00	178	0.20	5	8.20	208	8.50	216	3538045007EO	\$171.20	16	7	1200
6	150	6.63	168	5.00	127	0.25	6	10.90	278	6.50	165	3538066305EO	\$303.20	23	10	1030
		6.63	168	7.00	178	0.25	6	10.90	278	8.50	216	3538066307EO	\$354.30	26	12	1030
8	200	8.63	219	5.00	127	0.25	6	12.90	329	6.50	165	3538086305EO	\$243.00	28	13	810
		8.63	219	7.00	178	0.25	6	12.90	329	8.50	216	3538086307EO	\$262.30	32	15	810
10	250	10.00	254	7.00	178	0.25	6	14.30	364	6.50	279	3538100007EO	\$322.90	38	17	700
		10.75	273	5.00	127	0.25	6	15.10	383	8.50	165	3538107505EO	\$298.30	34	15	660
		10.75	273	7.00	178	0.25	6	15.10	383	6.50	216	3538107507EO	\$345.10	40	18	660
12	300	12.00	305	5.00	127	0.25	6	16.30	414	8.50	216	3538120005EO	\$475.20	37	17	590
		12.00	305	7.00	178	0.25	6	16.30	414	6.50	279	3538120007EO	\$519.80	44	20	590
		12.75	324	5.00	127	0.25	6	17.10	433	8.50	165	3538127505EO	\$494.20	39	18	560
		12.75	324	7.00	178	0.25	6	17.10	433	6.50	216	3538127507EO	\$540.50	46	21	560
14	350	14.00	356	5.00	127	0.25	6	18.30	465	8.50	216	3538140005EO	\$505.30	41	19	510
		14.00	356	7.00	178	0.25	6	18.30	465	6.50	279	3538140007EO	\$535.70	48	22	510
16	400	16.00	406	7.00	178	0.25	6	20.30	516	8.50	279	3538160007EO	\$654.40	56	25	450
18	450	18.00	457	7.00	178	0.25	6	22.40	570	6.50	279	3538180007EO	\$682.00	81	37	410
20	500	20.00	508	7.00	178	0.25	6	24.40	621	8.50	279	3538200007EO	\$831.10	91	41	360
22	550	22.00	559	7.00	178	0.25	6	26.40	672	6.50	279	3538220007EO	\$891.90	98	44	330
24	600	24.00	610	7.00	178	0.25	6	28.40	722	28.40	279	3538240007EO	\$1,038.20	106	48	310
26	650	26.00	660	7.00	178	0.25	6	30.30	768	10.00	254	3538260007EO	\$1,484.40	113	51	277
28	700	28.00	711	7.00	178	0.25	8	32.30	819	10.00	254	3538280007EO	\$1,534.80	122	55	257
30	750	30.00	762	7.00	178	0.25	6	34.30	870	10.00	254	3538300007EO	\$1,578.40	131	59	240
		32.00	813	7.00	178	0.38	9.5	37.10	943	10.00	254	3538300007EO	POA	199	90	335
36	900	36.00	914	7.00	178	0.25	6.4	40.30	1022	11.00	279	353836A007EO	POA	160	73	201
		36.00	914	7.00	178	0.38	9.5	41.10	1045	10.00	254	353836B007EO	POA	221	100	298
42	1100	42.00	1067	7.00	178	0.38	9.5	47.10	1197	14.00	356	3538420007EO	POA	258	117	257
		42.00	1067	10.00	254	0.38	9.5	47.10	1197	11.50	292	3538420010EO	POA	307	139	257

MODEL 3538 COUPLING

Nominal Pipe Size		Pipe OD Range		Barrel Length Dim-A		Barrel Thickness Dim-B		Gland OD Dim-C		Overall Length Dim-D		Coupling		Weight		Working Pressure PSI
Inches	MM	Inches	MM	Inches	MM	Inches	MM	Inches	MM	Inches	MM	Catalog Number	List Price	lbs	kgs	
48	1200	48.00	1219	7.00	178	0.38	9.5	53.10	1349	14.50	368	3538480007EO	POA	295	134	226
		48.00	1219	10.00	254	0.38	9.5	53.10	1349	11.50	292	3538480010EO	POA	351	159	226
		48.00	1219	7.00	178	0.50	12.7	53.10	1349	14.50	368	353848C007EO	POA	320	145	299
		48.00	1219	10.00	254	0.50	12.7	53.10	1349	11.50	292	353848D010EO	POA	394	179	299
54	1350	54.00	1372	10.00	254	0.38	9.5	59.10	1502	14.50	368	353854A010EO	POA	395	179	202
		54.00	1372	10.00	254	0.50	12.7	59.10	1502	14.50	368	353854B010EO	POA	444	201	267
60	1500	60.00	1524	10.00	254	0.38	9.5	65.10	1654	14.50	368	353860A010EO	POA	439	199	180
		60.00	1524	10.00	254	0.50	12.7	65.10	1654	14.50	368	353860B010EO	POA	491	223	241
66	1700	66.00	1676	10.00	254	0.38	9.5	71.10	1807	14.50	368	353866A010EO	POA	483	219	165
		66.00	1676	10.00	254	0.50	12.7	71.10	1807	14.50	368	353866B010EO	POA	540	245	220
72	1800	72.00	1829	10.00	254	0.38	9.5	77.10	1959	14.50	368	353877A010EO	POA	526	239	151
		72.00	1829	10.00	254	0.50	12.7	77.10	1959	14.50	368	353877B010EO	POA	590	268	202

MODEL 3539 INSULATED COUPLING

CENTER BARREL: Carbon Steel per ASTM A53 or ASTM A 283 or Carbon Steel.

GLANDS: Carbon Steel per AISI C1020.

BOLTS & NUTS: Low Alloy Steel per ASTM A325, ASTM A563, and AWWA C111.

INSULATING BOOT: Neoprene per ASTM D2000.

GASKET: SBR per ASTM D2000. Suitable for mild acids, water, and salt media with a temperature range of -25° F to -200° F. Optional materials available.

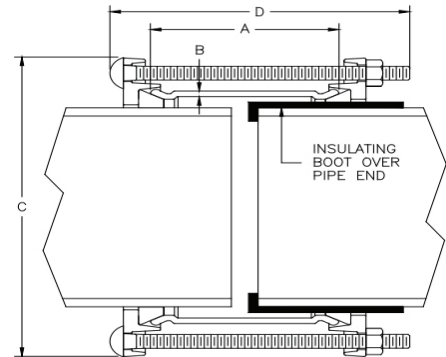

Nominal Pipe Size		Pipe OD Range		Barrel Length Dim-A		Barrel Thickness Dim-B		Gland OD Dim-C		Overall Length Dim-D		Coupling		Weight	
Inches	MM	Inches	MM	Inches	MM	Inches	MM	Inches	MM	Inches	MM	Catalog Number	List Price	lbs	kgs
2	50	2.38	60	5.00	127	0.22	6.0	6.30	159	8.50	216	3539023805EO	POA	6	3
3	80	3.50	89	5.00	127	0.24	6.0	7.00	178	8.50	216	3539035005EO		11	5
4	100	4.50	114	5.00	127	0.26	6.6	8.30	210	8.50	216	3539048005EO		16	7
6	150	6.63	168	5.00	127	0.25	6.4	11.40	289	8.50	216	3539066305EO		26	12
8	200	8.63	219	7.00	178	0.25	6.4	13.20	335	11.00	279	3539086307EO		39	17
10	250	10.75	273	7.00	178	0.38	8.0	15.60	395	11.00	279	3539107507EO		41	19
12	300	12.75	324	7.00	178	0.38	8.0	17.20	437	11.00	279	3539127507EO		43	20
14	350	14.00	356	7.00	178	0.38	8.0	18.80	476	11.00	279	3539140007EO		74	34
16	400	16.00	406	7.00	178	0.38	8.0	20.80	527	11.00	279	3539160007EO		86	39
18	450	18.00	457	7.00	178	0.38	8.0	22.80	578	11.00	279	3539180007EO		94	43
20	500	20.00	508	7.00	178	0.38	8.0	24.80	629	11.00	279	3539200007EO		105	78
22	550	22.00	559	7.00	178	0.38	8.0	26.80	679	11.00	279	3539220007EO		114	52
24	600	24.00	610	7.00	178	0.38	8.0	28.80	730	11.00	279	3539240007EO		125	57