

ADAPTERS

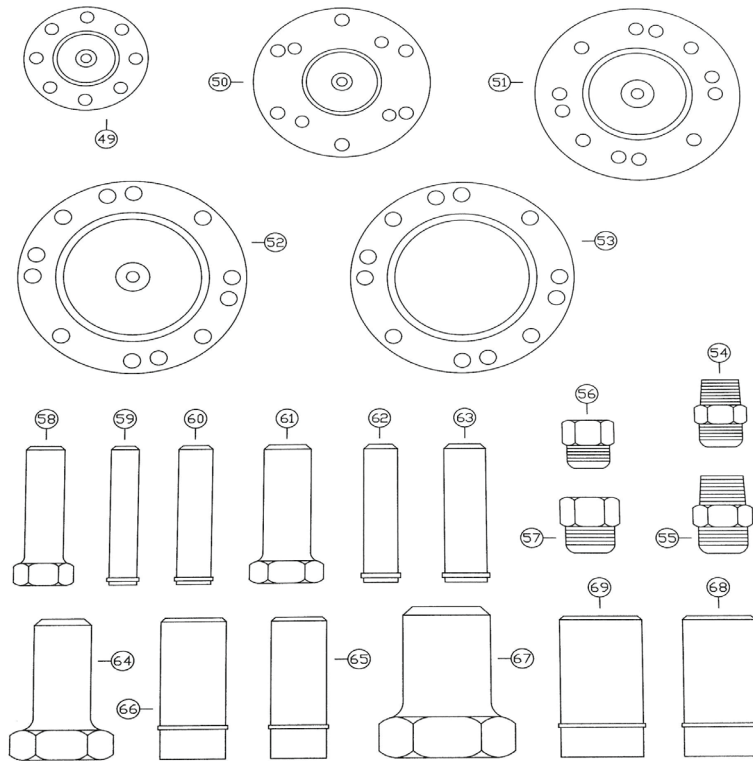

Catalog Number	Component Description	List Price	Illustration Key
3975F	3/4" Flare Adapter	\$90.50	41
3975C	3/4" CTS Compression Adapter	\$90.50	42
3975I	3/4" IPS Compression Adapter	\$90.50	43
3901F	1" Flare Adapter	\$103.40	44
3901C	1" CTS Compression Adapter	\$103.40	45
3901I	1" IPS Compression Adapter	\$103.40	46
3902F	2" Female Iron Pipe (FIP) Adapter	\$152.10	47
3902H*	2" NPT X 1 1/2" NPT Bushing	\$47.30	48
3903D	3" Pack-Off Plate (Flanged & MJ Valve)	\$169.70	49
3904D	4" Pack-Off Plate (Flanged & MJ Valve)	\$188.80	50
3906D	6" Pack-Off Plate (Flanged & MJ Valve)	\$424.00	51
3908D	8" Pack-Off Plate (Flanged & MJ Valve)	\$690.70	52
3908F	8" Adapter Plate Bushing	\$328.50	53
3975Q	3/4" Male Iron Pipe (MIP) X Flare Bushing	\$37.30	54
3901Q	1" Male Iron Pipe (MIP) X Flare Bushing	\$37.30	55
3975R	3/4" Female Iron Pipe (MIP) X Flare Bushing	\$37.30	56
3901R	1" Female Iron Pipe (MIP) X Flare Bushing	\$37.30	57
9075F	3/4" C900 Flare Adapter	\$117.00	58
9075C	3/4" C900 CTS Compression Adapter	\$117.00	59
9075I	3/4" C900 IPS Compression Adapter	\$117.00	60
9100F	1" C900 Flare Adapter	\$130.40	61
9100C	1" C900 CTS Compression Adapter	\$130.40	62
9100I	1" C900 IPS Compression Adapter	\$130.40	63

ADAPTERS

Catalog Number	Component Description	List Price	Illustration Key
9150F	1 1/2" Flare Adapter	\$180.80	64
9150C	1 1/2" C900 CTS Compression Adapter	\$180.80	65
9150I	1 1/2" C900 IPS Compression Adapter	\$180.80	66
9200F	2" Flare Adapter	\$192.30	67
9200C	2" C900 CTS Compression Adapter	\$192.30	68
9200I	2" C900 IPS Compression Adapter	\$192.30	69

ADAPTERS DETAIL

* Use with the 2" FIP Adapter to make a 1 1/2" FIP Adapter.

This illustration shows the assembly of a 3/4 inch Vega Drill and Compression Adapter to a compression Corporation Stop.

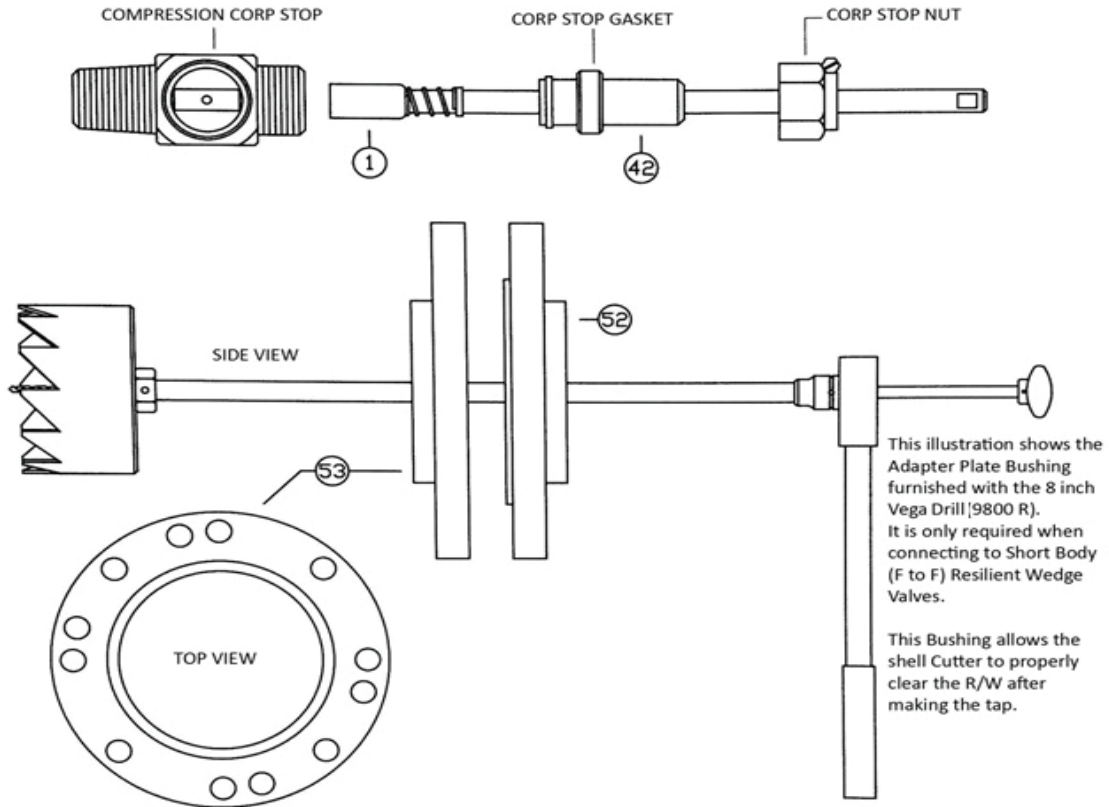

This illustration to the right shows that the Pack-Off Plate Adapters are designed to connect to both Flanged and Mechanical Joint Valves. The Adapter is shipped with a Flat Face Flange Gasket glued in place, but the Adapter can be reversed in the field and used with a Standard MJ Gasket.

This design feature also requires the two different Bolt Circle patterns as shown.

