



PowerSeal

PIPELINE PRODUCTS CORPORATION



Specialities
January 2015

3900 COMPLETE UNITS FOR IPS THIN WALL PLASTIC PIPE

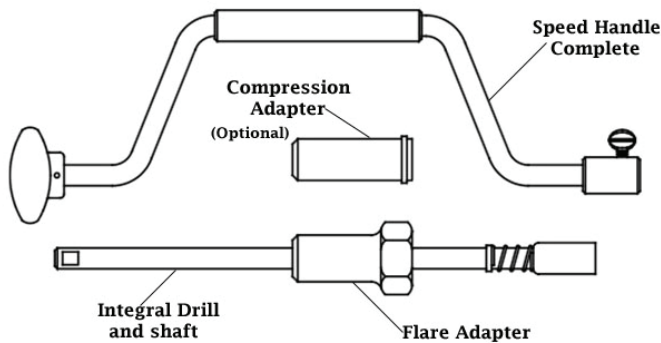

*Complete units consist of Drill, Drive Mechanism, and type of adapter specified.

*The Vega Drill Speed Handle Drive Mechanism is available only on 3/4" & 1" units. *The 1 1/2" & 2" units are furnished with Female Iron Pipe (FIP) threaded Adapters unless otherwise specified.

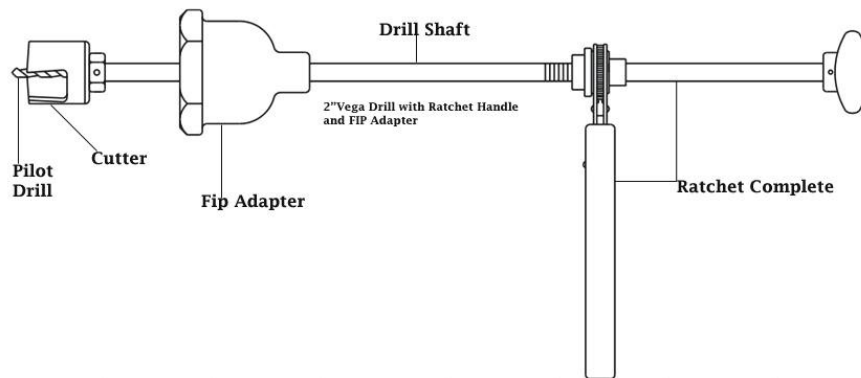

Model Number	Size		Drive Mechanism	Catalog Number			List Price
				Flare Adapter	Compression Adapters		
	Inches	MM			IPS	CTS	
3975S	3/4	20	Speed Handle	3975S00	3975S01	3975S02	\$ 309.00
3975R	3/4	20	Ratchet Handle	3975R00	3975R01	3975R02	\$ 524.60
3901S	1	25	Speed Handle	3901S00	3901S01	3901S02	\$ 332.60
3901R	1	25	Ratchet Handle	3901R00	3901R01	3901R02	\$ 548.00
3915R	1 1/2	40	Ratchet Handle	3915R00	3915R01	3915R02	\$ 738.30
3902R	2	50	Ratchet Handle	3902R00	3902R01	3902R02	\$ 718.60

HOW TO ORDER: Include Model Number and two-digit item code ending which specifies the type of adapter desired.

Example: To order a 3/4" unit w/Speed Handle and Flare Adapter, specify **Part Number:** 3975S00. To order a 1" unit w/ Ratchet and CTS Compression Adapter, specify Part Number: 3901R02.

NOTE: See Series 9000 for Larger Diameter Drills.

NOTE: Model 3902R without a two digit adapter code behind it will be supplied with a 2" FIP adapter (3902F).

NOTE: For 3/4" and 1" sizes Female Iron Pipe (FIP) or Male Iron Pipe (MIP) thread Flare bushing available. These bushings work in conjunction with the standard flare adapter, converting them from a flared copper thread to iron pipe thread. See parts page in adapters section.

4900 COMPLETE UNITS FOR PLASTIC SEWER PIPE “Y” CONNECTIONS

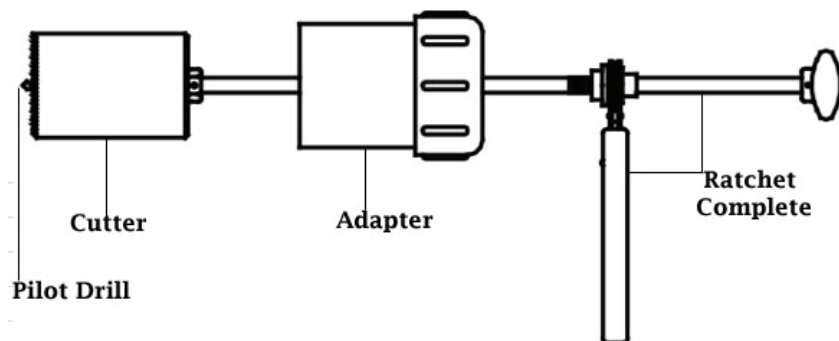

*Complete units consist of Sewer Cutter, Ratchet, Shaft, and Adapter.

*The Sewer Cutter is an elongated hole saw for tapping PVC sewer pipe at a 45° angle.

4" Sewer Vega Drill with Ratchet Handle and Guide Adapter.

Catalog Number	Size		Drive Mechanism	List Price
	Inches	MM		
4904R	4	100	Ratchet Handle	\$656.20
4906R	6	150	Ratchet Handle	\$984.40

HOW TO ORDER: Include Part Number.

Example: To order a 4" unit w/Ratchet Handle, specify **Part Number:** 4904R.

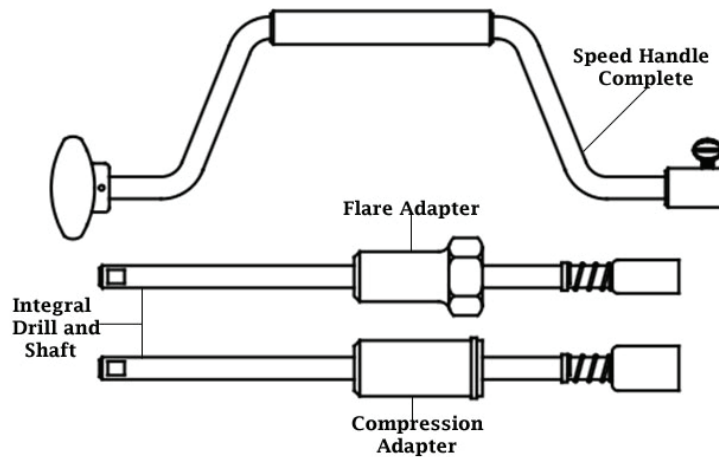
5900 COMBINATION UNITS FOR IPS THIN WALL PLASTIC PIPE ONLY

3/4" and 1" Combination Vega Drills with Speed Handle, 3/4" Flare Adapter and 1" Compression Adapter.

Model Number	Size		Drive Mechanism	Catalog Number			List Price
				Flare Adapter	Compression Adapters		
	Inches	MM			IPS	CTS	
5901S	3/4" & 1"	20 & 25	Speed Handle	5901S00	5901S01	5901S02	\$509.60
5901R	3/4" & 1"	20 & 25	Ratchet Handle	5901R00	5901R01	5901R02	\$708.10
5902R	3/4", 1", 1 1/2" & 2"	20,25,40 & 50	Ratchet Handle	5902R00	5902R01	5902R02	\$1,276.70

HOW TO ORDER: Specify Model Number and two-digit item code ending which specifies the type of adapter desired.

Example: To order a 3/4" and 1" combination unit with Ratchet Handle and Flare Adapters, specify **Part Number:** 5901R00.

NOTE: For 3/4" and 1" sizes Female Iron Pipe (FIP) or Male Iron Pipe (MIP) thread Flare bushing available. These bushings work in conjunction with the standard flare adapter, converting them from a flared copper thread to iron pipe thread. See parts page in adapters section.

NOTE2: Please advise customer service when requiring a 2" FIP adapter on the Model 5902R.

7900 COMPLETE UNITS FOR ASBESTOS CEMENT (A/C) PIPE

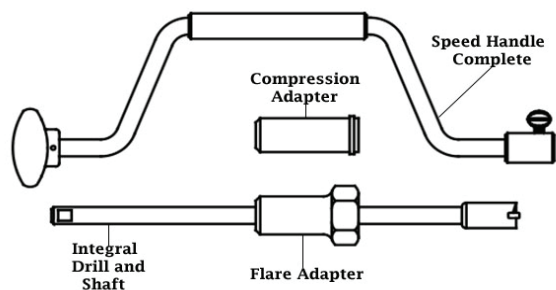

*Complete units consist of Drill, Drive Mechanism, and type of adapter specified. *The Vega Drill Speed Handle Drive Mechanism is available only on 3/4" & 1" units. *The 1 1/2" & 2" units are furnished with Female Iron Pipe (FIP) threaded Adapters unless otherwise specified. *3" thru 8" are furnished with "Pack-Off" plate style adapters that fit on both flanged and MJ fittings. *3/4" and 1" Drive Mechanisms are interchangeable. *1 1/2" thru 4" Drive Mechanisms are interchangeable. *6" & 8" Drive Mechanisms are interchangeable. *The 7900 Series Vega Drills are furnished with Carbide Tips for tapping A/C pipe.

3/4" A/C Vega Drill with Speed Handle and Flare Adapter. (Optional Compression Adapter also shown.)

Model Number	Size		Drive Mechanism	Catalog Number			List Price
				Flare Adapter	Compression Adapters		
	Inches	MM			IPS	CTS	
7975S	3/4	20	Speed Handle	7975S00	7975S01	7975S02	\$444.00
7975R	3/4	20	Ratchet Handle	7975R00	7975R01	7975R02	\$640.10
7901S	1	25	Speed Handle	7901S00	7901S01	7901S02	\$481.00
7901R	1	25	Ratchet Handle	7901R00	7901R01	7901R02	\$677.00
7915R	1 1/2	40	Ratchet Handle	7915R00	7915R01	7915R02	\$901.00
7902R	2	50	Ratchet Handle	7902R00	7902R01	7902R02	\$890.00
7903R	3	80	Ratchet Handle	-	-	-	\$1,087.30
7904R	4	100	Ratchet Handle	-	-	-	\$1,338.40
7906R	6	150	Ratchet Handle	-	-	-	\$2,150.70
7908R	8	200	Ratchet Handle	-	-	-	\$2,766.00

HOW TO ORDER: Specify Model Number and two-digit item code ending which specifies the type of adapter desired. Example: To order a 3/4" unit with Ratchet Handle and Flare Adapters, specify **Part Number:**7975R00.

NOTE: For 3/4" and 1" sizes Female Iron Pipe (FIP) or Male Iron Pipe (MIP) thread Flare bushing available. These bushings work in conjunction with the standard flare adapter, converting them from a flared copper thread to iron pipe thread. See parts page in adapters section.

9000 COMPLETE UNITS FOR C900 THICK WALL PLASTIC PIPE

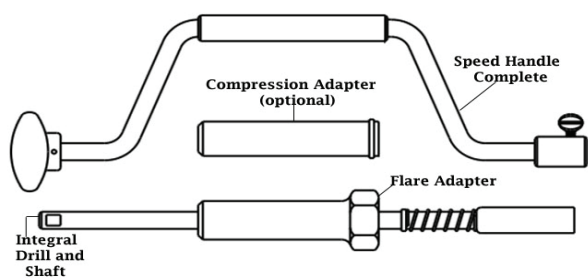

3/4" C900 Vega Drill with Speed Handle and Flare Adapter.
(Optional Compression Adapter also shown.)

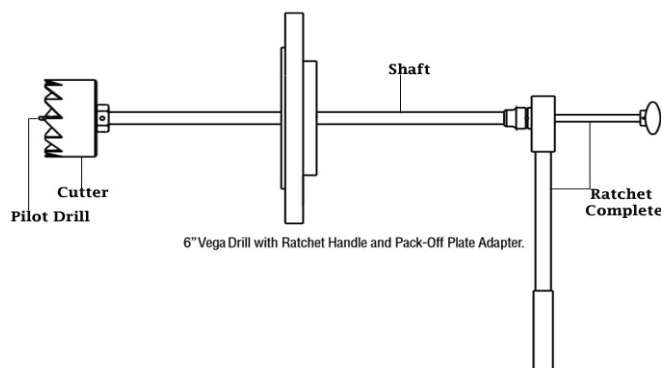

* Complete units consist of Drill, Drive Mechanism, and type of Adapter specified.* The Vega Drill Speed Handle Drive Mechanism is available only on 3/4" and 1" units. * 3/4" and 1" Drive Mechanisms are interchangeable.* 1 1/2" thru 4" Drive Mechanisms are interchangeable.* 6" & 8" Drive Mechanisms are interchangeable.* The 1 1/2" and 2" units are furnished with Female Iron Pipe (FIP) threaded adapter unless otherwise specified.* 3" thru 8" units are furnished with "Pack-Off" plate style adapters that fit on both flanged and MJ fittings.

HOW TO ORDER: On 3/4" thru 2" units, specify the Model Number, followed by the two-digit item code ending which specifies the type of Adapter desired.

Example: To order a 1" unit w/ Ratchet and IPS Compression Adapter, specify Part Number: 9100R01. On 3" thru 8" units, these models are furnished with "Pack-Off" plate style Adapters, so simply specify the Model Number. Example: To order a 6" unit, specify **Part Number:**9600R.

NOTE: For 3/4" and 1" sizes Female Iron Pipe (FIP) or Male Iron Pipe (MIP) thread Flare bushing available. These bushings work in conjunction with the standard flare adapter, converting them from a flared copper thread to iron pipe thread. See parts page in adapters section.

Model Number	Size		Drive Mechanism	Catalog Number			List Price
				Flare Adapter	Compression Adapters		
	Inches	MM			IPS	CTS	
9075S	3/4	20	Speed Handle	9075S00	9075S01	9075S02	\$343.30
9075R	3/4	20	Ratchet Handle	9075R00	9075R01	9075R02	\$537.70
9100S	1	25	Speed Handle	9100S00	9100S01	9100S02	\$379.60
9100R	1	25	Ratchet Handle	9100R00	9100R01	9100R02	\$575.80
9150R	1 1/2	40	Ratchet Handle	9150R00	9150R01	9150R02	\$753.60
9200R	2	50	Ratchet Handle	9200R00	9200R01	9200R02	\$776.00
9300R	3	80	Ratchet Handle	-	-	-	\$789.80
9400R	4	100	Ratchet Handle	-	-	-	\$855.00
9600R	6	150	Ratchet Handle	-	-	-	\$1,461.20
9800R	8	200	Ratchet Handle	-	-	-	\$1,880.30

SERIES 9900 COMBO COMPLETE UNITS FOR C900 THICK WALL PLASTIC PIPE

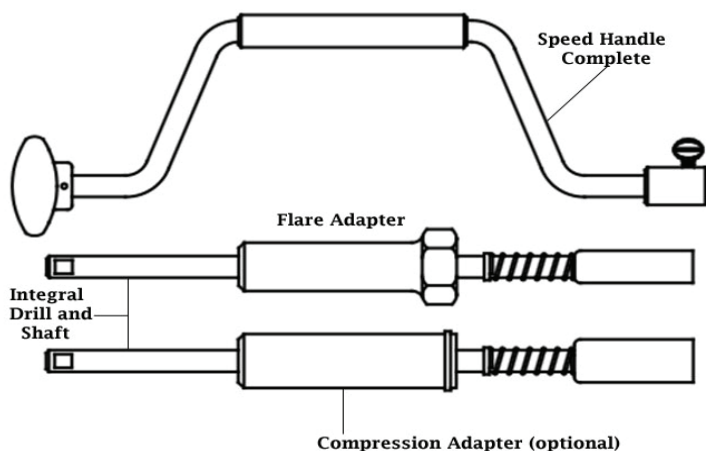

- * Combination units consist of Drills, Drive Mechanism, and type of Adapters specified.
- * The Vega Drill Speed Handle Drive Mechanism is available only on 3/4" and 1" units.
- * 1 1/2" & 2" units are furnished with Female Iron Pipe (FIP) threaded Adapters unless otherwise specified.
- * 3/4" and 1" Drive Mechanisms are interchangeable.
- * The 1 1/2" and 4" Drive Mechanisms are interchangeable.
- * 6" & 8" Drive Mechanisms are interchangeable.
- * 3" thru 8" units are furnished with "Pack-Off" plate style adapters that fit on both flanged and MJ fittings.

3/4" and 1" C900 Vega Drills with Speed Handle, 3/4" Flare Adapter, and 1" Compression Adapter.

Model Number	Size		Drive Mechanism	Catalog Number			List Price
				Flare Adapter	Compression Adapters		
	Inches	MM			IPS	CTS	
9901S	3/4" & 1"	20 & 25	Speed Handle	9901S00	9901S01	9901S02	\$651.00
9901R	3/4" & 1"	20 & 25	Ratchet Handle	9901R00	9901R01	9901R02	\$847.00
9902R	3/4", 1", 1 1/2" & 2"	40 & 50 20, 25,	Ratchet Handle	9902R00	9902R01	9902R02	\$1,627.00
9904R	2" & 4"	50 & 100	Ratchet Handle	-	-	-	\$1,370.70
9906R	6" & 8"	150 & 200	Ratchet Handle	-	-	-	\$2,787.60
9908R	ALL	ALL	Ratchet Handle	-	-	-	\$5,420.00

HOW TO ORDER: Show model number followed by two digit item code ending which specifies the type of adapter desired. Example: To order a 3/4" & 1" Combination unit with Speed Handle and Flare Adapters, specify **Part Number:** 9901S00. When ordering combination units, remember to specify the type of Adapter for Vega Drill sizes smaller than 3".

NOTE: On the Model 9908R all size combination unit you must specify all of your adapter choices when ordering.

NOTE: For 3/4" and 1" sizes Female Iron Pipe (FIP) or Male Iron Pipe (MIP) thread Flare bushing available. These bushings work in conjunction with the standard flare adapter, converting them from a flared copper thread to iron pipe thread. See parts page in adapters section.

DRILLS & CUTTERS

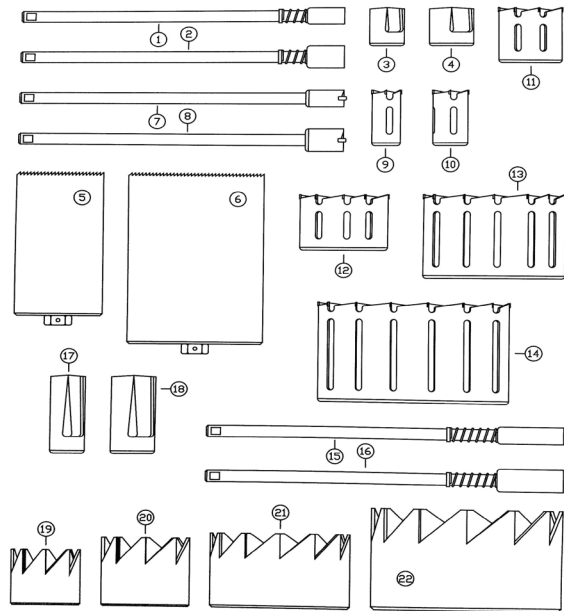

Catalog Number	Component Description	List Price	Illustration Key
3975A	3/4" Drill for IPS (Thin Wall)	\$119.00	1
3901A	1" Drill for IPS (Thin Wall)	\$127.30	2
3915A	1 1/2" Shell Cutter for IPS (Thin Wall)	\$135.60	3
3902A	2" Shell Cutter for IPS (Thin Wall)	\$165.00	4
4904A	4" Sewer Shell Cutter	\$283.90	5
4906A	6" Sewer Shell Cutter	\$350.40	6
7975A	3/4" Carbide Tip A/C Drill	\$281.80	7
7901A	1" Carbide Tip A/C Drill	\$305.80	8
7915A	1 1/2" Carbide Tip A/C Drill	\$376.40	9
7902A	2" Carbide Tip A/C Drill	\$412.60	10
7903A	3" Carbide Tip A/C Drill	\$592.40	11
7904A	4" Carbide Tip A/C Drill	\$824.50	12
7906A	6" Carbide Tip A/C Drill	\$1,172.60	13
7908A	8" Carbide Tip A/C Drill	\$1,521.10	14
9075A	3/4" C-900 Drill (Integral Shank)	\$154.20	15
9100A	1" C-900 Drill (Integral Shank)	\$177.30	16
9150A	1 1/2" C-900 Shell Cutter	\$217.40	17
9200A	2" C-900 Shell Cutter	\$287.80	18
9300A	3" C-900 Shell Cutter	\$237.10	19
9400A	4" C-900 Shell Cutter	\$329.80	20
9600A	6" C-900 Shell Cutter	\$468.90	21

DRILLS & CUTTERS

Catalog Number	Component Description	List Price	Illustration Key
9800A	8" C-900 Shell Cutter	\$608.50	22
9075DP	3/4" Cutter for /Dual Purpose Shank	\$190.00	29
9100DP	1" Cutter for /Dual Purpose Shank	\$284.60	30

DRILLS & CUTTERS - HANDLES - ADAPTERS

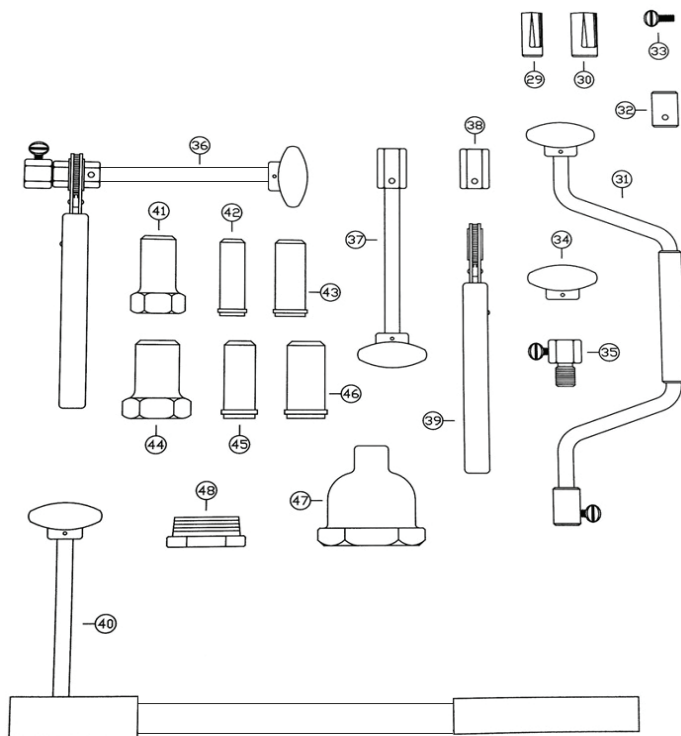

Catalog Number	Component Description	List Price	Illustration Key
3901J	Complete Speed Handle for 3/4" & 1" Drill	\$71.90	31
3901J1	Speed Handle Coupler	\$16.10	32
3901J2	Speed Handle Thumb Screw	\$2.00	33
3901J3	Knob Only for Speed Handle	\$20.70	34
3901P	P- Adapter for 3/4" and 1" Ratchet	\$41.90	35
3902D	Complete Ratchet for Sizes Below 6"	\$268.20	36
3902D1	Ratchet Knob, Shaft & Coupler Only (Specify 3/4" or 7/8")	\$67.10	37
3902D2	Ratchet Coupler Only (Specify 3/4" or 7/8")	\$22.90	38
3902D3	Ratchet Only for Sizes Below 6" (Specify 3/4" or 7/8")	\$137.90	39
3906I	Complete Ratchet for 6" and 8" Drill	\$468.70	t

ADAPTERS

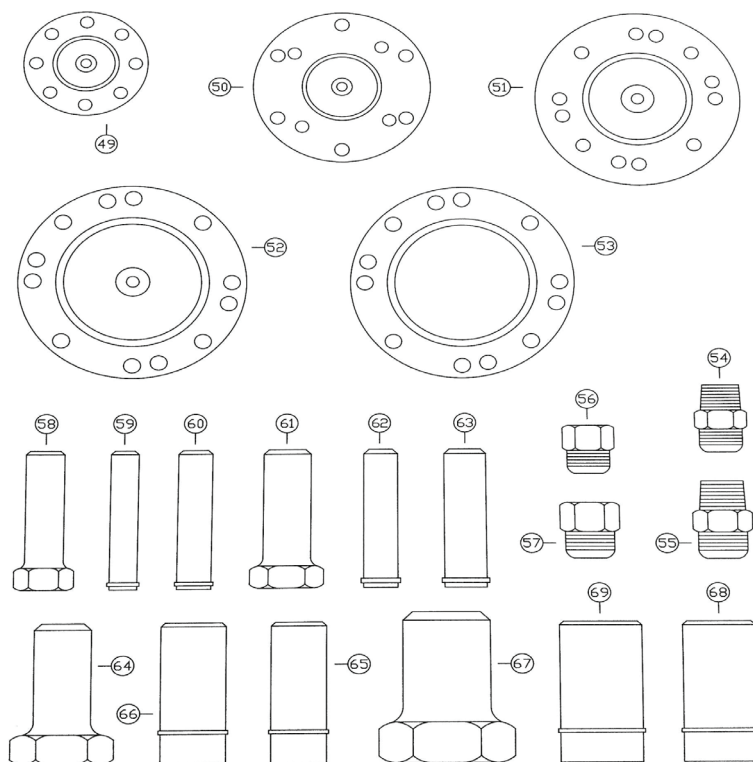

Catalog Number	Component Description	List Price	Illustration Key
3975F	3/4" Flare Adapter	\$90.50	41
3975C	3/4" CTS Compression Adapter	\$90.50	42
3975I	3/4" IPS Compression Adapter	\$90.50	43
3901F	1" Flare Adapter	\$103.40	44
3901C	1" CTS Compression Adapter	\$103.40	45
3901I	1" IPS Compression Adapter	\$103.40	46
3902F	2" Female Iron Pipe (FIP) Adapter	\$152.10	47
3902H*	2" NPT X 1 1/2" NPT Bushing	\$47.30	48
3903D	3" Pack-Off Plate (Flanged & MJ Valve)	\$169.70	49
3904D	4" Pack-Off Plate (Flanged & MJ Valve)	\$188.80	50
3906D	6" Pack-Off Plate (Flanged & MJ Valve)	\$424.00	51
3908D	8" Pack-Off Plate (Flanged & MJ Valve)	\$690.70	52
3908F	8" Adapter Plate Bushing	\$328.50	53
3975Q	3/4" Male Iron Pipe (MIP) X Flare Bushing	\$37.30	54
3901Q	1" Male Iron Pipe (MIP) X Flare Bushing	\$37.30	55
3975R	3/4" Female Iron Pipe (MIP) X Flare Bushing	\$37.30	56
3901R	1" Female Iron Pipe (MIP) X Flare Bushing	\$37.30	57
9075F	3/4" C900 Flare Adapter	\$117.00	58
9075C	3/4" C900 CTS Compression Adapter	\$117.00	59
9075I	3/4" C900 IPS Compression Adapter	\$117.00	60
9100F	1" C900 Flare Adapter	\$130.40	61
9100C	1" C900 CTS Compression Adapter	\$130.40	62
9100I	1" C900 IPS Compression Adapter	\$130.40	63

ADAPTERS

Catalog Number	Component Description	List Price	Illustration Key
9150F	1 1/2" Flare Adapter	\$180.80	64
9150C	1 1/2" C900 CTS Compression Adapter	\$180.80	65
9150I	1 1/2" C900 IPS Compression Adapter	\$180.80	66
9200F	2" Flare Adapter	\$192.30	67
9200C	2" C900 CTS Compression Adapter	\$192.30	68
9200I	2" C900 IPS Compression Adapter	\$192.30	69

ADAPTERS DETAIL

* Use with the 2" FIP Adapter to make a 1 1/2" FIP Adapter.

This illustration shows the assembly of a 3/4 inch Vega Drill and Compression Adapter to a compression Corporation Stop.

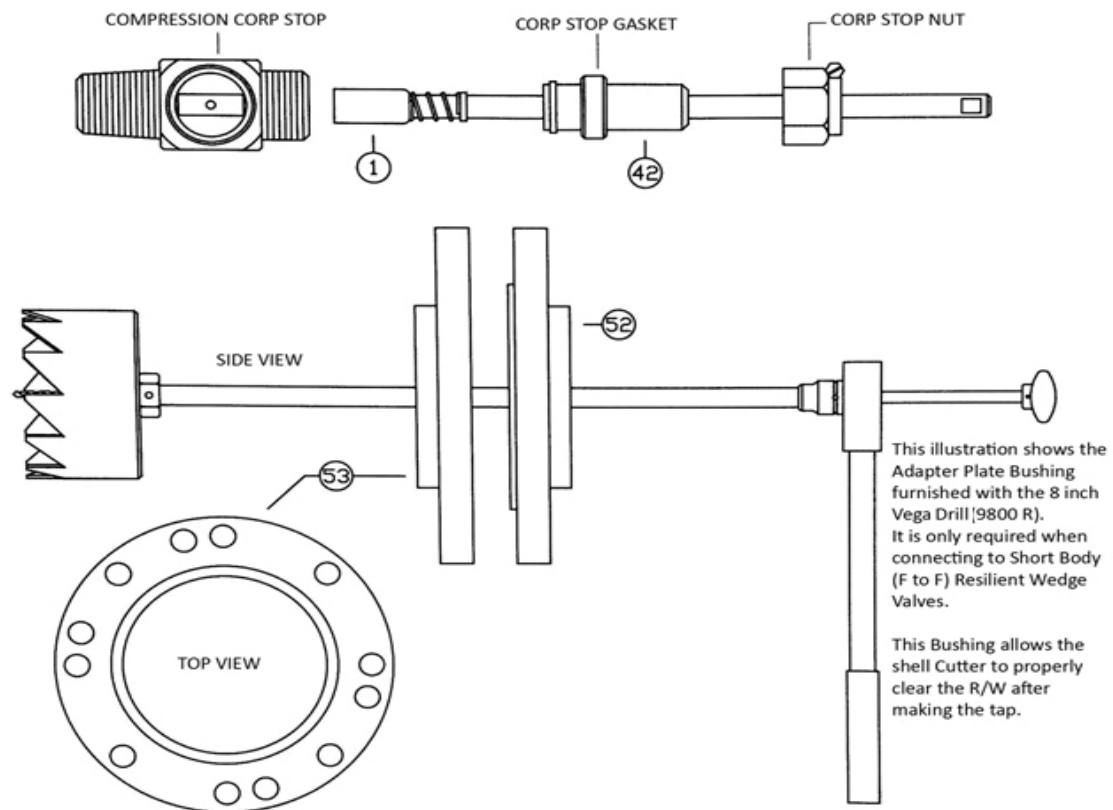

This illustration to the right shows that the Pack-Off Plate Adapters are designed to connect to both Flanged and Mechanical Joint Valves. The Adapter is shipped with a Flat Face Flange Gasket glued in place, but the Adapter can be reversed in the field and used with a Standard MJ Gasket.

This design feature also requires the two different Bolt Circle patterns as shown.

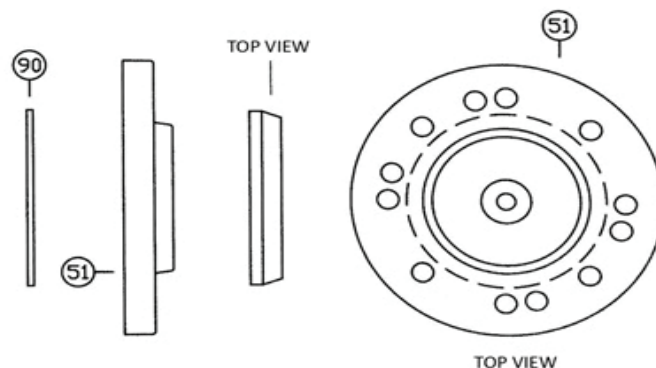

MISC. PARTS / VEGADRILLS

Catalog Number	Component Description	List Price	Illustration Key
3905F	Shaft Only for 1 1/2", 2", 3" & 4" Cutters	\$57.30	70
3905F1	Jam Nut (5/8") for 2" & 4" Shaft	\$2.70	71
3906T	Shaft Only for 6" and 8" Shell Cutter	\$85.40	72
9200T	Shaft for 1 1/2" & 2" C900 Shell Cutter	\$75.50	73
3902G	1 1/2" & 2" Pilot Drill	\$11.60	74
9200G	1 1/2" & 2" C900 Pilot Drill	\$14.20	75
3903G	3" Pilot Drill	\$11.60	76
3904G	4" Pilot Drill	\$11.60	77
3906G	6" Pilot Drill	\$14.20	78
3908G	8" Pilot Drill	\$27.20	79
3901Y	SpiraLok Ring & Washer for 3/4" & 1" Drills	\$3.20	80
3901Z	Chip Retainer Spring for 3/4" & 1" Drills	\$3.40	81
9100Z	Chip Retainer Spring for 3/4" & 1" C900 Drills	\$6.90	82
3901V	Small O-Ring for 3/4" and 1" Adapters	\$2.00	83
3901W	Larger O-Ring for 3/4" Flare Adapter	\$2.10	84
3901X	Large O-Ring for 1" Flare Adapter	\$2.30	85
3904F	O-Ring for 2" FIP Adapter & 3" and 4" Pack-Off Plate	\$2.00	86
3906F	O-Ring for 6" and 8" Pack-Off Plate	\$2.00	87
3903E	3" Pack-Off Plate Gasket	\$12.10	88
3904E	4" Pack-Off Plate Gasket	\$12.10	89
3906E	6" Pack-Off Plate Gasket	\$18.10	90
3908E	8" Pack-Off Plate Gasket	\$21.80	91

MISC

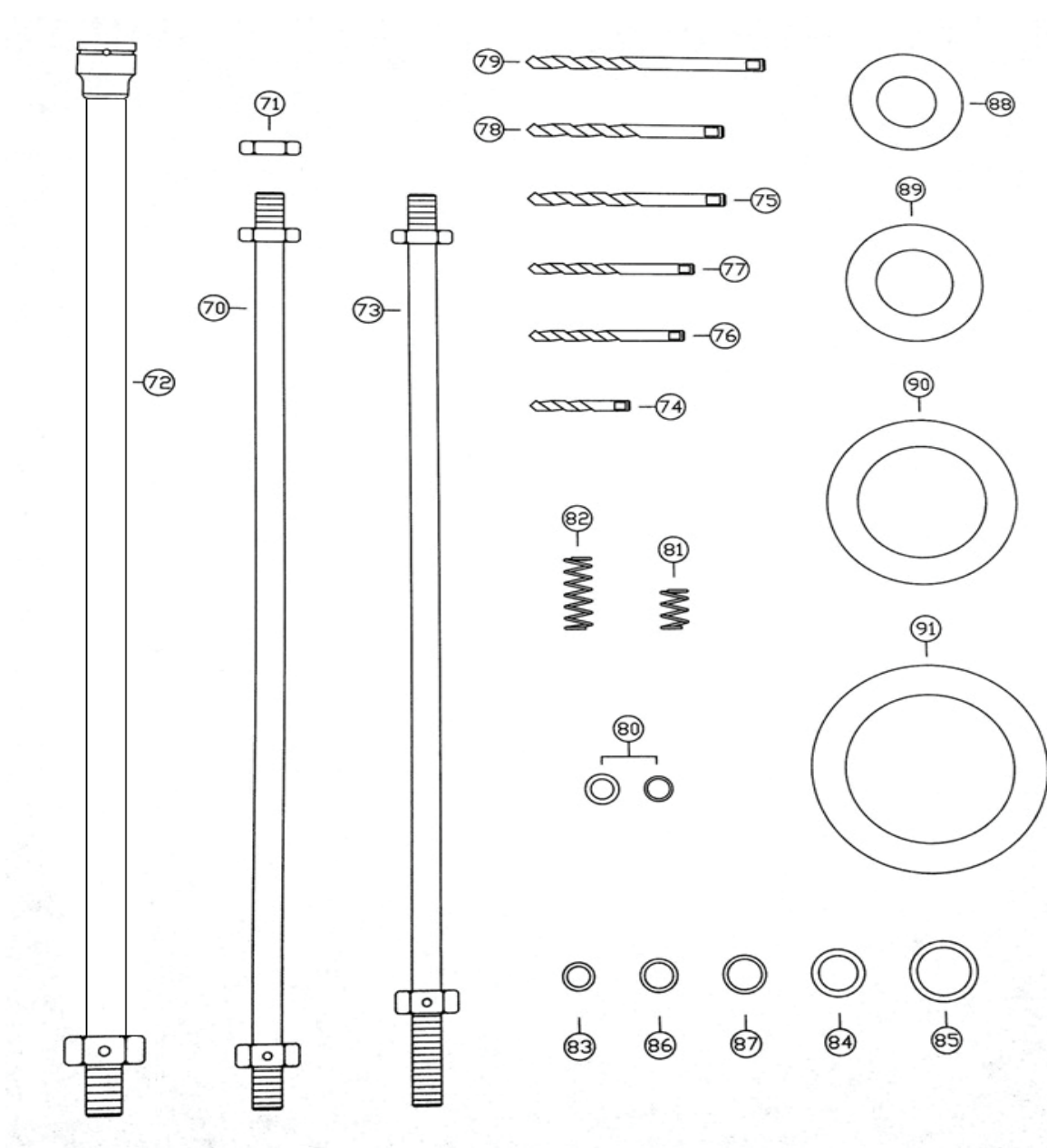

MODEL 4810 CASING CHOCK

RISER: Type 304 (18-8) Stainless Steel per ASTM A240 or Carbon Steel per ASTM A36.

LINER: Elastomeric PVC per ASTM D149.

CHOCK SKID: Glass Reinforced Nylon or UHMW Polyethylene per ASTM D638.

FASTENERS: Type 304 (18-8) Stainless Steel per ASTM A193.



PLEASE CONSULT FACTORY FOR PRICING

The Model 4810 Casing Chock is a versatile pipeline fitting that can be custom engineered for most carrier/casing pipe applications such as:

- Correcting improperly graded sewer casings.
- Centering pipeline rehabilitation slip lining carriers.
- Positioning insulated pipe without damaging insulation.
- Placing gravity sewer lines to on-grade requirements.

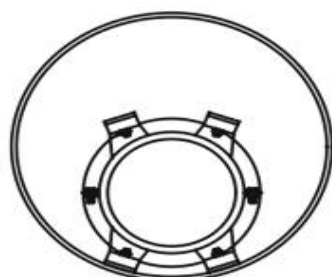

STANDARD

Standard

The standard design allows the carrier to clear the bell only.

Center Restrained

The Centered option positions and restrains the main carrier in the center of the casing to provide maximum space for other use and maintain grade.

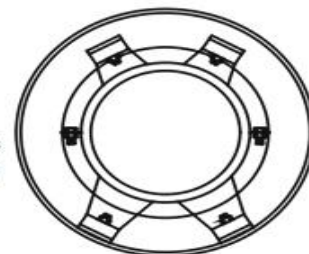

CENTERED

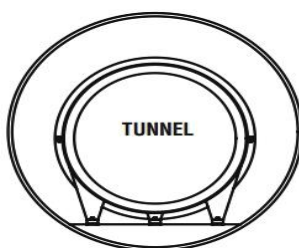

Tunnel Chocks

Large diameter casing tunnels which previously required track systems for the carrier pipe can be accommodated with casing chocks designed to provide full support to a concrete "tunnel floor".

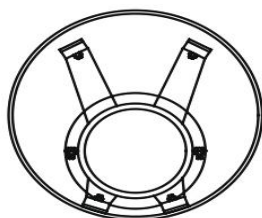

BOTTOM

Bottom Restrained

Bottom Restrained Chock allows for the clearance of the Bell only yet provides restraint from floating within the casing.

MultiCarrier
Allows casing pipe to be fitted with two or more carrier pipes and/or electrical or communication conduits.

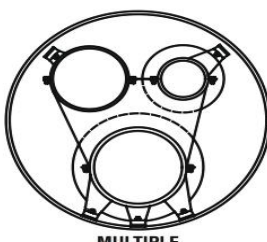

MULTIPLE

MODEL 4810 CASING CHOCK

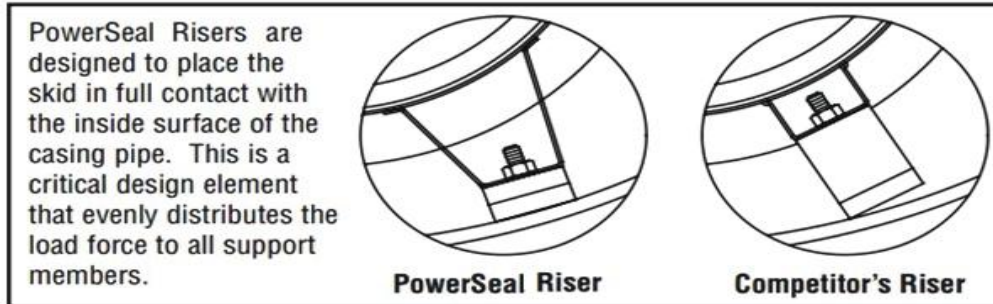

When ordering casing chocks please provide the following information:

- Engineering Firm Name, Job Name, and quote number.
- Outside Diameter and manufacturer of Carrier Pipe.
- Type of Joint, i.e. Mechanical Joint, Push-On, Flanged, Restrained, etc.
- Inside Diameter and Type of Casing Pipe.
- Length of Casing and/or Quantity of Chocks.
- Casing Chock Design, ie. Standard, Center restrained for example.
- Special installation requirements such as Leak Detection Cable, Special Clearance, etc.

HOW TO ORDER: To order a spacer to carry a 6" C900 pipe inside 16" 1/4" wall casing pipe order **Part Number:** 4810690155CA

First four numbers are Model Number, next three are Carrier Pipe OD, next three are Casing Pipe ID, first letter is the design (S= Standard, C= Centered, B= Bottom), second letter is the Chock width (A= 8", B= 12").

Add -CS after this to denote Carbon Steel Chocks. Part Number: 4810690155CA-CS

4860 POLYETHYLENE CASING CHOCK



PANEL HDPE Polyethylene ASTM D638.

RISER: HDPE Polyethylene ASTM D638.

CHOCK SKID: HDPE Polyethylene ASTM D638.

FASTENERS: Stainless Steel (304) ASTM A193.

Nominal Sizes	Effective Skid Height	Number of Runners	Number of Segments	Part Number	List Price
2 X 4-6	9/16"	6	2	4860238060NM	\$ 7.50
3 X 6-8	7/8"	6	2	4860350080NM	\$ 10.40
4 X 6-8	9/16"	6	2	4860450080NM	\$ 17.30
6 X 10-12	1	6	2	4860663120NM	\$ 23.00
8 X 12-14	1	6	2	4860863140NM	\$ 28.40
10 X 14-16	1	6	2	4860107160NM	\$ 32.90
12 X 16-18	1	6	2	4860127180NM	\$ 40.60
14 X 18-20	1	12	4	4860140180NM	\$ 47.70
16 X 20-22	1	12	4	4860160220NM	\$ 53.10
18 X 22-24	1	15	5	4860180240NM	\$ 59.20
20 X 24-26	2	15	5	4860200260NM	\$ 66.40
22 X 26-28	3	18	6	4860220300NM	\$ 72.40
24 X 28-30	4	18	6	4860240300NM	\$ 79.70
26 X 30-32	5	21	7	4860260320NM	\$ 85.70
28 X 32-34	6	21	7	4860280340NM	\$ 93.00
30 X 34-36	7	24	8	4860300360NM	\$ 99.00
32 X 34-36	8	24	8	4860320400NM	\$ 106.10
34 X 38-40	9	27	9	4860340420NM	\$ 112.30
36 X 40-42	10	27	9	4860360420NM	\$ 119.50
38 X 42-44	11	30	10	4860380440NM	\$ 125.60
40 X 44-46	12	30	10	4860400460NM	\$ 132.80
42 X 46-48	13	33	11	4860420480NM	\$ 138.90
44 X 48-50	14	33	11	4860440500NM	\$ 146.10
46 X 50-52	15	36	12	4860460520NM	\$ 152.10
48 X 52-54	16	36	12	4860480540NM	\$ 153.40

HOW TO ORDER: To order a spacer for a 4" IPS pipe inside 8" casing pipe order **Part Number:** 4860450080NM

4890 POLYETHYLENE CASING CHOCK

PANEL: HDPE Polyethylene ASTM D638.

RISER: HDPE Polyethylene ASTM D638.

CHOCK SKID: HDPE Polyethylene ASTM D638.

FASTENERS: Stainless Steel (304) ASTM A193.

FOR USE ON C900 AND DI PIPE OD'S



Carrier Size		Minimum Casing Size	Diameter Over Runners	Number of Runners	Number of Segments	Width	Part Number	List Price
In	MM							
4	100	10"	9 1/8"	6	2	4"	4890048100NM	\$ 25.80
6	150	12"	10 15/16"	6	2	4"	4890690120NM	\$ 28.10
8	200	16"	14 7/16"	6	2	4"	4890905160NM	\$ 30.60
10	250	18"	16 1/4"	6	2	4"	4890111180NM	\$ 32.60
12	300	20"	18 1/8"	6	2	4"	4890132200NM	\$ 36.30

NOTE: Special Rubber Inserts available to convert Poly Spacers to fit IPS, SDR26 & 35.

HOW TO ORDER: To order a spacer for a 6" C900 pipe inside 12" casing pipe order **Part Number:** 4890690120NM

END SEALS FOR CASING PIPE CLOSURES

The PowerSeal wraparound design facilitates installation when the carrier line has already been installed and the job is complete. Pull on design available per request .

Simply wrap the EndSeal around the carrier and casing pipes, press the industrial grade adhesive strips together, and secure with the stainless steel clamps.

EndSeals may be manufactured for any carrier/casing differential. They are used to create a seal between the carrier pipe and casing to insure filler material is maintained within or foreign objects kept out of the annular space.

And, unlike link-type sealing blocks that are limited by the carrier/casing differential and can only be used on a concentric profile, these EndSeals are totally flexible. They are constructed from 1/8" thick synthetic rubber assuring excellent chemical resistance and resiliency.

These products out perform the costly and labor intensive brick and mortar method of sealing casing ends.

While soil stress and pipe movement cause mortar to crack, the EndSeal moves with the pipe, insuring the integrity of the seal.

HOW TO ORDER First four numbers are model number, next three are casing pipe O.D., next three are carrier pipe O.D. EXAMPLE: A 30" casing pipe (30.00 O.D.) holding a 12" pipe (13.20 O.D.). Order **Part Number:** 4810300132ES.

Add -PO after this to denote Pull On Model. **Part Number:** 4810300132ES-PO

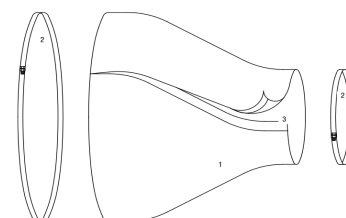

- 1 - Elastomeric Body
- 2 - Stainless Steel Clamps
- 3 - Adhesive Seal

MODEL 5000 VALVE BOX ALIGNER

PREVENTS VALVE MISALIGNMENT AND INSULATES

BODY: 1/4 Carbon Steel per ASTM A36.

FINISH: Standard protective Epoxy coating.

GASKET: SBR from 100% new rubber with superior storage characteristics.

Suitable for mild acids, water and salt media.



Valve Size		Gate Valve Manufacturer	Catalog Number	List Price
4	100	US Pipe	500004000USP	\$260.00
		Waterous	500004000WTS	
		Mueller	500004000MUE	
		Kennedy	500004000KEN	
6	150	US Pipe	500006000USP	\$276.30
		Waterous	500006000WTS	
		Mueller	500006000MUE	
		Kennedy	500006000KEN	
8	200	US Pipe	500008000USP	\$281.70
		Waterous	500008000WTS	
		Mueller	500008000MUE	
		Kennedy	500008000KEN	
10	250	US Pipe	500010000USP	\$287.00
		Waterous	500010000WTS	
		Mueller	500010000MUE	
		Kennedy	500010000KEN	
12	300	US Pipe	500012000USP	\$319.50
		Waterous	500012000WTS	
		Mueller	500012000MUE	
		Kennedy	500012000KEN	
16	400	US Pipe	500016000USP	\$368.30
		Waterous	500016000WTS	
		Mueller	500016000MUE	
		Kennedy	500016000KEN	



THE BEST WAY TO MEASURE PIPES

The PowerSeal O.D. Tape is available to measure up to 24" and 36" diameters. A light weight pocket size tape measure. Perfect for all those who work in the field, from engineers to laborers.



24" (600 mm)

Catalog Number	Size	List Price
6001	24" 600mm	\$ 24.80

36" (900 mm)

Catalog Number	Size	List Price
6001-36	36" 900mm	\$ 27.30



Measure the pipe in a quick and easy way. Wrap the O.D. Tape around the pipe and you will have your exact O.D.

Available in IN/OD and METRIC/OD.

Ask factory about personalized tapes (Add your company logo)

Set up cost apply (One time fee)

MODELS 6960, 6961 & 6962 RATCHET SETS WITH DEEP SOCKETS

All PowerSeal Ratchet Sets come with deep sockets, which aid in the installation of PowerSeal Repair Clamps, Saddles, Tapping Sleeves, and Couplings.

All kits include ratchet, 6" deep sockets, and a specially designed box to carry your ratchets. The 6" deep sockets facilitate proper field installations. Furthermore, the 6" deep sockets function with almost any style of ratchet.

Model Number	Size	Catalog Number	List Price
6961	1 5/16	696111516	\$450.00
	1 1/16	696111116	
	1 1/4	696111114	
	1 1/8	696111118	



MANHOLE ID MARKERS

BODY: Type 304 (18-8) Stainless Steel per ASTM A240

TOP: 1/4" thick and 3.20" diameter.

LENGTH: 3 1/4" long.

THREADED: 5/8-11 UNC rolled thread.

The perfect manner for identifying manhole covers, valves, and water and sewer line locations. Made entirely out of 304 stainless steel which adds to the quality and image of your municipality.

Description	Catalog Number	List Price
Manhole ID Valve on Eastside	82100PS16000	\$50.70
Manhole ID Valve on Center	82100PS18000	\$50.70
Manhole ID Valve on Westside	82100PS93000	\$50.70
Manhole ID Valve on Southside	82100PS14000	\$50.70
Manhole ID Valve on Northside	82100PS17000	\$50.70
Sanitary Sewer Manhold ID	82100PS20000	\$50.70
Manhole ID Valve on Eastside with Threads	82100PS16T00	\$61.30
Manhole ID Valve on Center with Threads	82100PS18T00	\$61.30
Manhole ID Valve on Westside with Threads	82100PS93T00	\$61.30
Manhole ID Valve on Southside with Threads	82100PS14T00	\$61.30
Manhole ID Valve on Northside with Threads	82100PS17T00	\$61.30
Sanitary Sewer Manhold ID with Threads	82100PS20T00	\$61.30
Sanitary Sewer Manhold ID with Logo	82100PS20L00	\$74.10
Sanitary Sewer Manhold ID with Logo	82100PS20TL0	\$79.60
Manhole ID Valve on Southside with Threads, with Logo, with Hydrant	82100PS15TLH	\$79.60

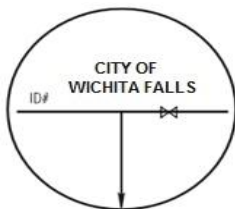

Valve on Eastside



Valve on Westside



Valve on Northside

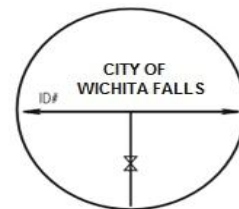

Valve on Southside

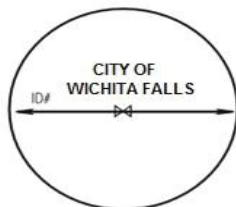

Valve on Center



Sewer ID w/ logo

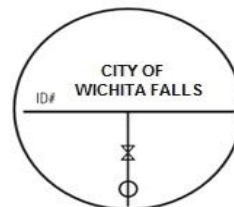

Valve on Southside with Hydrant

8010P 18X18 POLY BOX W/LOCKING LID



RING AND LID: Cast Iron per ASTM A536.
BODY: Poly blend, black exterior white interior with raised knockouts.
LOCKING MECHANISM: Bronze per ASTM B584, AWWA C800 (85-5-5).



RING AND LID: Cast Iron per ASTM A536.
BODY: Galvanized 16 Gauge
LOCKING MECHANISM: Bronze per ASTM B584, AWWA C800.

Various Box Sizes and Lid options available upon request

8000 C.I MUSHROOM LID: Cast Iron per ASTM A48

Catalog Number	
8000060000-M	
List Price	POA



8070 C.I VALVE BOX: Cast Iron per ASTM A48

Catalog Number	
8070000000CI-W	
List Price	POA



Water Meter Lid OFF

Ductile Iron Per ASTM A536 Locking Mechanism
Bronze per ASTM B584, AWWA C800 (85-5-5)



Catalog Number	
801018X00WL0-OFF	
List Price	POA

Sewer Lid available upon request

Water Meter Key ON: Ductile Iron Per ASTM A536



Catalog Number	
801000000WMK	
List Price	POA

Water Meter Key OFF: Ductile Iron Per ASTM A536



Catalog Number	
801000000WMK-O	
List Price	POA